



GGC– Quebec Council
100 Alexis-Nihon Suite 270
St-Laurent, QC H4M 2N7

Tel: 514-933-5839
1-800-565-8111
Fax: 514-933-7591

www.guidesquebec.ca
guides-quebec@bellnet.ca

INSIDE THIS ISSUE:

Membership Day at Sears	2
Quebec Participate Challenge	4
iMIS Rosters	5
News from the Property Committee	9
Wa-Thik-Ane	10
Fall Day Camp	11

The Piccolo

June 2011

Membership Growth = Making a Difference in the World

Growing Guiding in Quebec ensures that we live up to our promise of 'taking action for a better world'. Confident, resourceful and courageous girls build stronger communities.

Spring Pre-registration
is now **closed!**

Did your District win the challenge?
Find out in the **August 2011 Piccolo**

Fall Registration is just around the corner. Start spreading the news – Make a difference in the life of a new member and they're sure to make a difference in yours!!



Together we can grow Guiding and 'make a difference in the world'

Tammy Leclair on behalf of the Quebec Membership Growth Team

Membership Day at Sears



This is a great opportunity to showcase all that Guiding has to offer girls and women in the greater community at a 'can't be missed' location.

Sears Canada has generously extended an invitation again this year for Girl Guides of Canada-Guides du Canada to set up Membership Information tables in Sears, Sears Home and Outlet stores on **Saturday, August 20** across Canada, during Sears' "Back to School" event.

Sears Membership Day will help:

- promote Guiding in your community
- provide girls and their parents with information on local units
- showcase local Guiding Units/Branches
- hand out promotional materials directing parents to our new convenient Online Registration System and answer questions about registering girls online
- hand out A.1s to women who show interest in volunteering

Membership Day at Sears is not limited to participation by Unit Guiders. A team can be created comprising of adult or Girl Members, Link and Trefoil Guild Members, and/or Commissioners – anyone with sound knowledge of local Guiding activities that can be a great spokesperson for this event.

Unit Guiders who wish to use the event to grow their own Unit may do so. However, through our communications and GGC promotion material they can also provide information on other Branches/ages programming for the girls in their community.

Encourage the participation of Girl Members to give personal endorsements of the Guiding experience. Girl Members requiring 'volunteer hours' can use time spent at this event towards those hours.

What You Need to Know

Key Dates

June 3	Online sign up begins
July 22	Online sign up ends
July 25 – Aug 5	Shipping of "Membership Day in a Box" materials
August 2	Information / map available on the GGC National website
August 8	Final confirmation of details with Member contacts
August 20	Membership Day at Sears

How to Sign Up

This year, Districts, Communities or Units wanting to take part in this opportunity at Sears will do so by **registering their participation on-line at the National website**. A registration web form is available through [Member Zone -> Membership -> Membership Day at Sears](#). Participants will provide a key contact name, her iMIS number and complete address, then choose the store location they wish to participate at from a drop down menu, and the length of time they will be in attendance.

Times will be reserved according to the date of registration received. Participants will be contacted by the National office to confirm their participation. If they need to change their time or cancel the event they will do so by e-mailing the contact in their confirmation e-mail. This type of detail will be covered in the confirming e-mail.

Continued on next page...

...continued from previous page

Confirming with Sears

The store will be contacted and the time booked by the National Office and confirmed with the group. Locations and times will be promoted on the National website. Unless a Guider has a long standing relationship with Sears, all stores should be booked centrally by the National Office.

Promotion and Registration Materials

The event has been promoted in the June Guidepost with instructions on how to sign up. An additional reminder will go out in the July Guidepost.

Prior to the event, the Member contact will receive by mail a complete "Guiding in a Box" package, with information on online registration for participating provinces, Girl and Adult registration forms, signs and other promotional material for use at this event.

Promotion to the Public

The event will be promoted on the National GGC website, as well as through PSAs, in-store announcements, and the Sears flyer which is delivered to homes across the country. Visitors to the website will be able to access a map to view participating stores and times.

FAQ

Q. Does every District/Community have to participate in this event?

A. No, this is not a mandatory Membership event but an opportunity to promote Guiding to girls and their families who may not be aware that Guiding is available in their town, community or area.

Q. Can only Unit Guiders attend?

A. No, we hope that Unit Guiders will attend but this is a general Membership/promotional event, not just for a particular unit. Commissioners, Members-at-Large, Advisers, Trefoil Guild Members, Rangers, Links and Girls from other Branches can all assist with this event.

Q. Why is this event so early in August?

A. This is the time parents begin to look for activities for their children and 'back to school' events are on in stores. It is great time to bring Community Guiding to the forefront of girls and their parents. It is also to take advantage of Sears' "Back to School" event.

Q. How many women should be at the table?

A. A minimum of two adults or an adult and youth Member.

Q. Do we have to cover the full day?

A. If you are planning to be at a store you should try to cover at least three hours - but do what your volunteers for the event are able to do.

Q. Can units use Membership Day at Sears to also take registrations for their Unit?

A. For participating provinces, the emphasis should be on promoting the benefits of Guiding and promoting online registration as a fast, easy, convenient way of registering their daughter/ward, with immediate confirmation. For adults and for provinces using paper registration for girls, you can use this as a Unit's registration event.



Quebec pARTicipate Challenge 2011

CAMPFIRE PLANNING

- See **February or March Piccolo** for details
- The Campfire Planning Challenge will continue throughout 2011

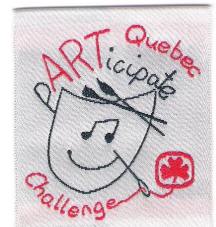
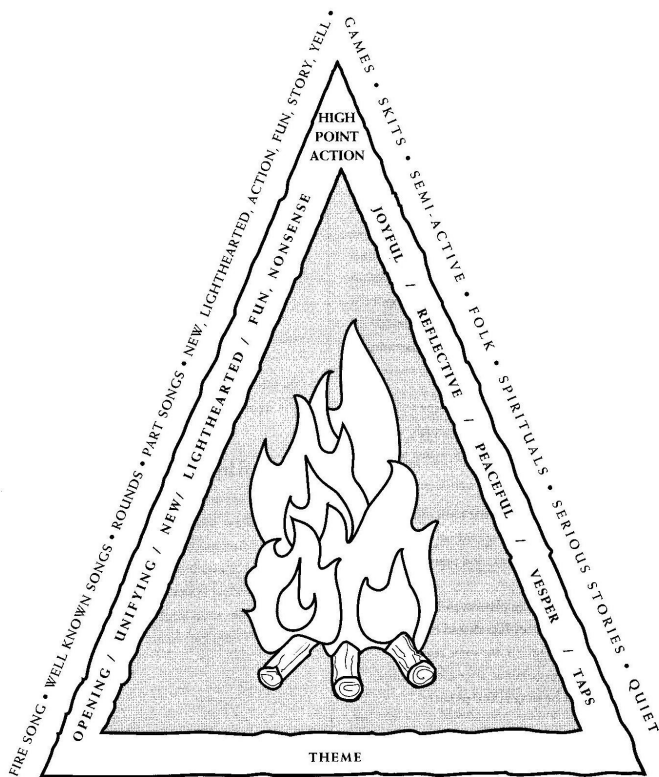

CONGRATULATIONS to the following Units who submitted the plans of their **THREE COMPLETED CAMPFIRES** and have received their crests!

1st Chambly Sparks, des Montregiennes District
3rd Chambly Brownies, des Montregiennes District
2nd Lakeshore Guides, Lakeshore District
1st Argenteuil Spark Unit, Mille Iles District
1st Two Mountains Spark Unit, Mille Iles District
1st Two Mountains Brownie Unit, Mille Iles District
1st Two Mountains Girl Guides, Mille Iles District
1st Richmond Guiding Unit
3rd Riverdale Sparks, Riverdale District
7th Ste. Genevieve Brownies, Riverdale District
3rd Riverdale Guides, Riverdale District

WATCH FOR OUR QUEBEC CHALLENGE CAMPFIRE in the August/September Piccolo.

Check out "Unit Activity Roster (next Guiding Year)" in IMIS to see the list of girls registered for 2011-2012 in your Unit! Brenda is typing them in as fast as she can...keep checking the list for updates.

- To see your Current Year Roster
- (2010-2011)
and your ever-growing 2011-2012 Roster

Check this out!

<https://memberzone.girlguides.ca/Communication>

Click on:

- My IMIS
- IMIS Central
- Roster Reports

New !

Unit Roster Updates 2011-2012

Save your 2010-2011 Unit Roster before June 30th – so you can reach the girls who forgot to register for 2011-2012!



Starting July 1st – the 2010-2011 Rosters will be gone, print your list so you can follow up with girls to re-register!

1

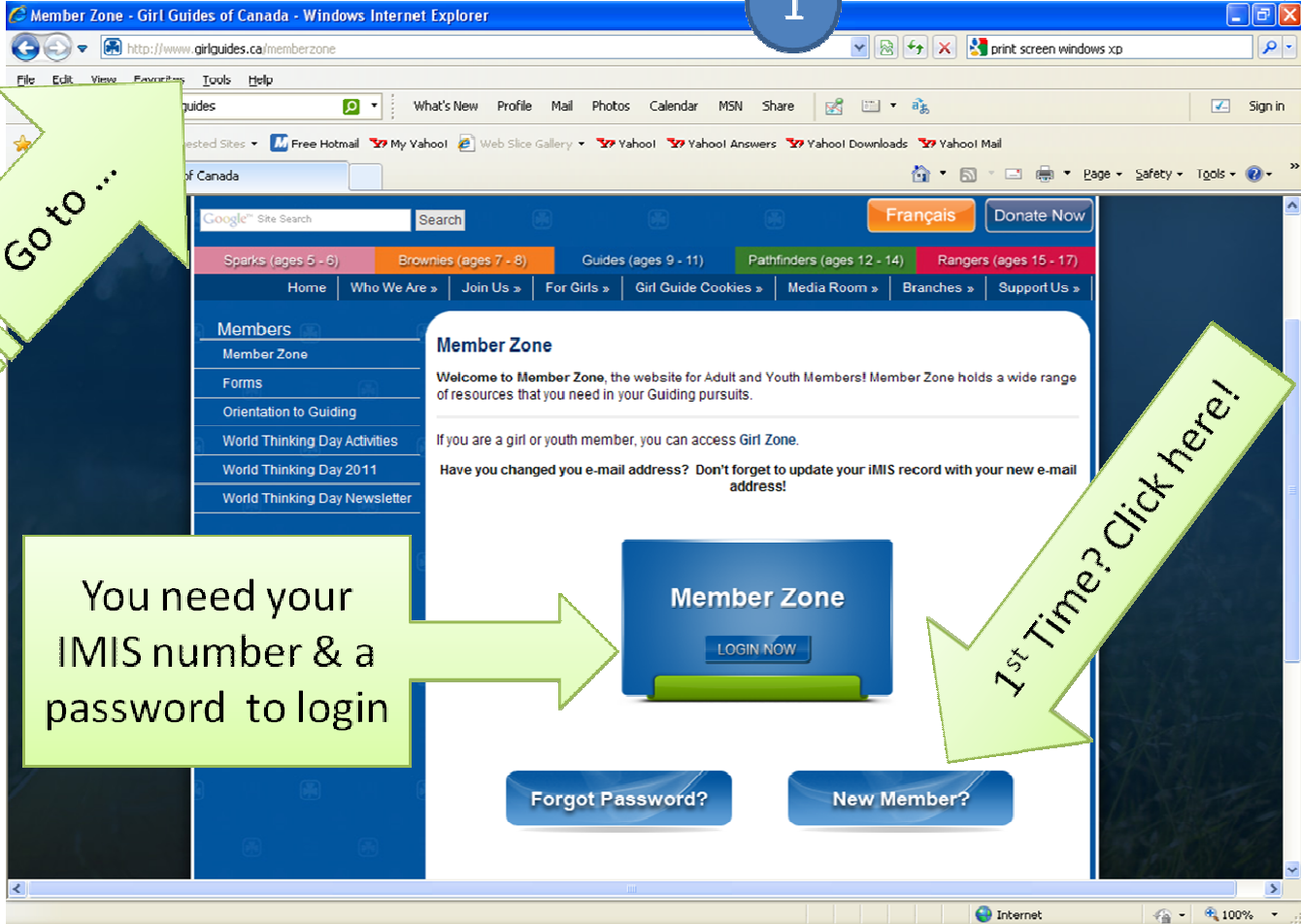

You need your IMIS number & a password to login

Member Zone
LOGIN NOW

Forgot Password?

New Member?

New to Memberzone ?
Just fill in this page and a password will be sent to your e-mail box

2

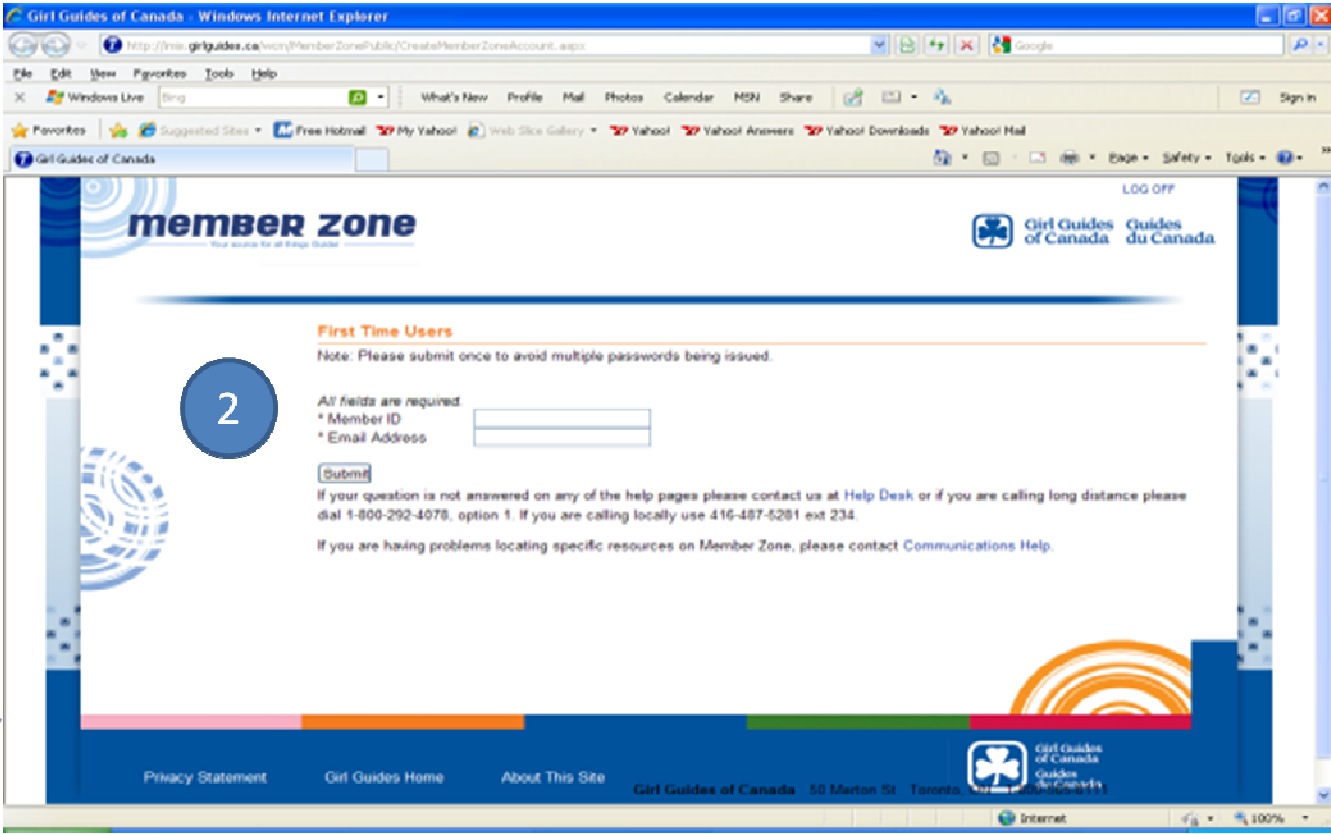

3

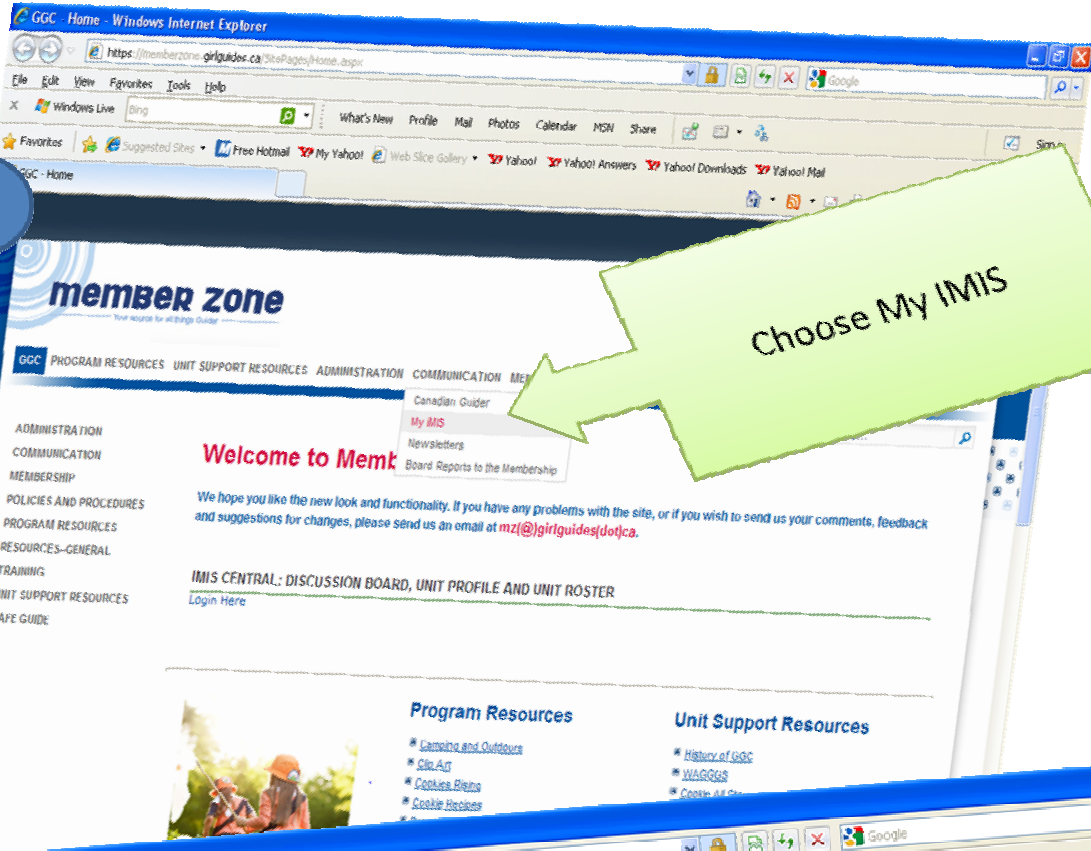

Choose My iMIS

4

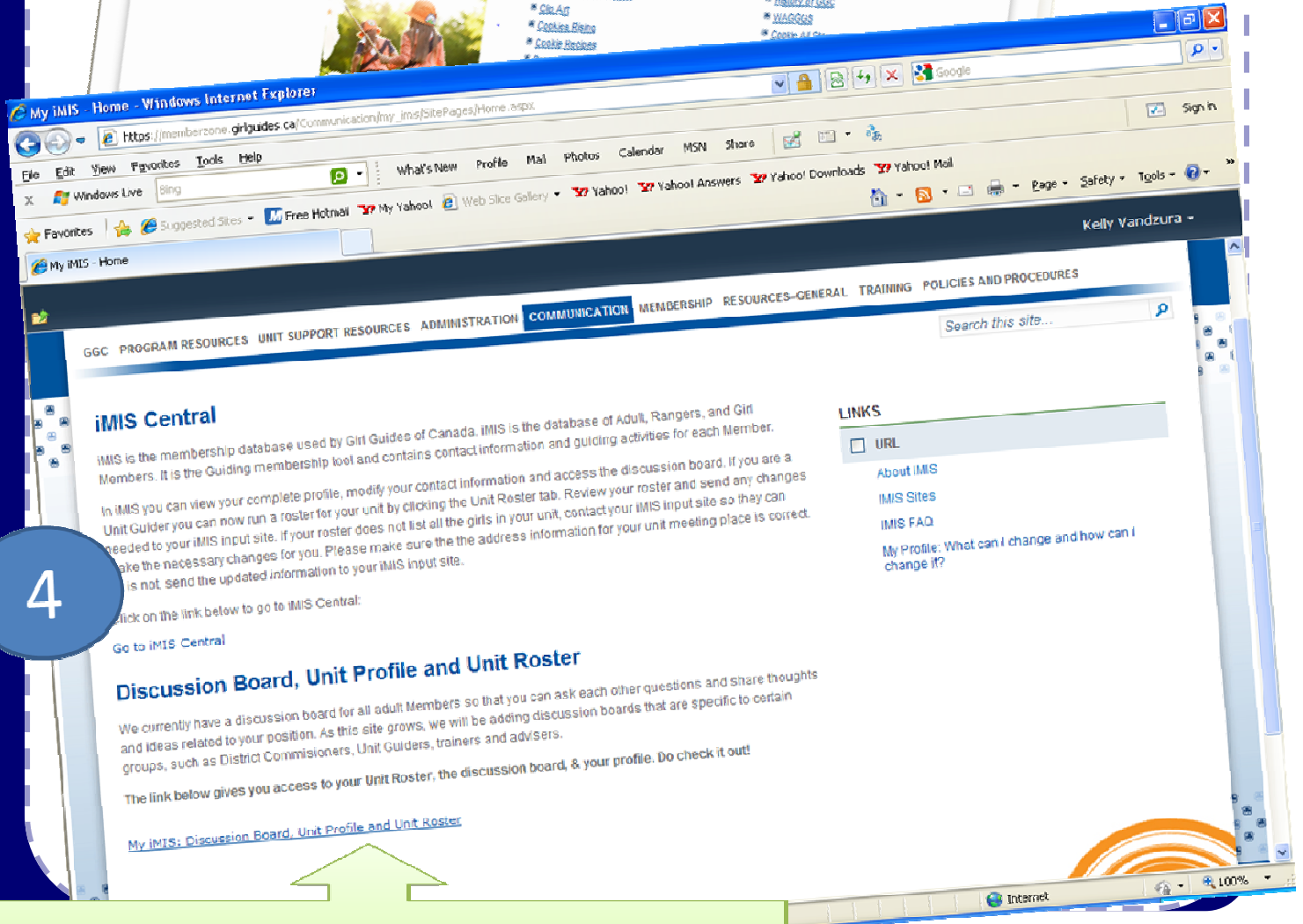

See your personal iMIS info as well as access your Unit Rosters here!

Windows Internet Explorer

http://imis.girlguides.ca/wcm/portal/default.aspx

File Edit View Favorites Tools Help

Windows Live Bing What's New Profile Mail Photos Calendar MSN Share Sign in

Favorites Suggested Sites Free Hotmail My Yahoo! Web Slice Gallery Yahoo! Yahoo! Answers Yahoo! Downloads Yahoo! Mail

IMIS Central Page Safety Tools

LOG OFF

IMIS Central

HOME

Welcome to **IMIS Central**

Think of this website as a toolbox that holds the wide range of resources that you need in your Guiding pursuits. Here you have easy access to the documents you reference most often, such as Safe Guide and Guiding Essentials, as well as all the forms and reference documents that pertain to your role in Guiding.

IMIS LINKS [Hide](#)

- Database Schema
- iMIS Help Site
- iMIS Community

GGC REPORTS [Hide](#)

SUPPORT

- Provincial Offices Helpdesk

MY IMIS

- Member Zone
- My Profile
- [Roster Reports](#)
- My Communities

5

Click here to see your Rosters or choose My Profile to make updates (new e-mail address, moving?)

http://imis.girlguides.ca/WCM/MemberZone/Reports/MemberZone/Reports/Unit_Roster_Reports.aspx

News from the Property Committee



Water for Wa-Thik-Ane Update

A **Big** thank you to everyone who has supported the many fundraising initiatives for the well at Wa-Thik-Ane. To date we have earned approximately \$3700.00 through several campaigns.

Community Shopping Night at Dix Mille Villages: On May 6th the Property Committee hosted an evening of shopping at Dix Mille Village, a fair trade boutique in Pointe-Claire. It was a fun and interesting evening with many girls and Guiders coming in to support the cause. During the evening we raised \$618.00. Many thanks to everyone involved.

April Fundraising Calendar: A big thank you to all who participated, distributed or talked about the well at Wa Thik Ane. If you have not already done so, please send your calendar money in the form of a unit or district cheque to: GGC- Quebec Council. Please put in the subject area '**calendar- Water for Wa Thik Ane**'.

e-Cause Eco Boutique: This campaign concluded at the end of May. Almost **700** items were purchased for total sales of \$5,592.56 and a profit to us of \$1,327.43. Our branded mesh ditty bags proved so popular that we have ordered extras to be sold up at camp and at various upcoming events. Anyone interested should contact Charyl at Charyl@videotron.ca. They make great gifts for the girls!!



Wa-thik-Ane's 85th Birthday Bash!

Camp Wa-Thik-Ane has been in operation since the summer of 1926. We have gone through many changes over the years but the spirit of the camp still remains in tact. Please set aside, **Saturday, August 13th** to join us at the campsite for a Birthday celebration. All of the details will be in the [July Piccolo](#).

New Tents at Iroquois

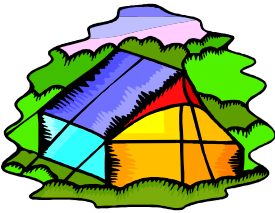

You will soon be seeing 6 new canvas tents and flys at Iroquois site. We would ask everyone to take very good care of all of the tents but especially the new ones as we need these to last us for many years to come. You might be surprised to know that this new equipment has cost the Province \$10,000. and it is up to all of us to make sure that this investment lasts for a long time!

New Contact Information: In order to simplify communication with the Property Committee we have set up a new e-mail address. Bookings are still handled by Shannon at the Provincial office but we can help you with [Wa-Thik-Ane campsite information](#). Please contact us at: qcpropertycommittee@gmail.com

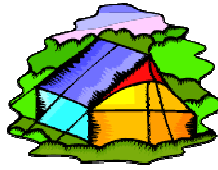

Book your Next Camp at Wa-Thik-Ane

It is never too early to start thinking about your next camp!! Why not make it at Wa-Thik-Ane? Camp Wa-Thik-Ane sits on the beautiful and pristine shores of Lac Bouchette. There are acres of natural forest to explore, beautiful trails to follow, developed campsites with wooden marquees for inclement weather, food preparation and consumption. We have a modern food building with walk in refrigerator for safe food storage. Current rental rates will remain the same for Fall 2011. We are currently in the process of redesigning our camp information package and our site registration form. For more information please contact the Property committee at: qcpropertycommittee@gmail.com

Service	Rate	Comments
Site Rental	\$10/per person /per night	Two night minimum
Site Rental	\$15/per person/ per night	One night rentals
Propane	\$10 per weekend	Rental of large tank
Water	\$8.60 /18 L bottle	This price includes delivery

All prices are subject to GST and PST.

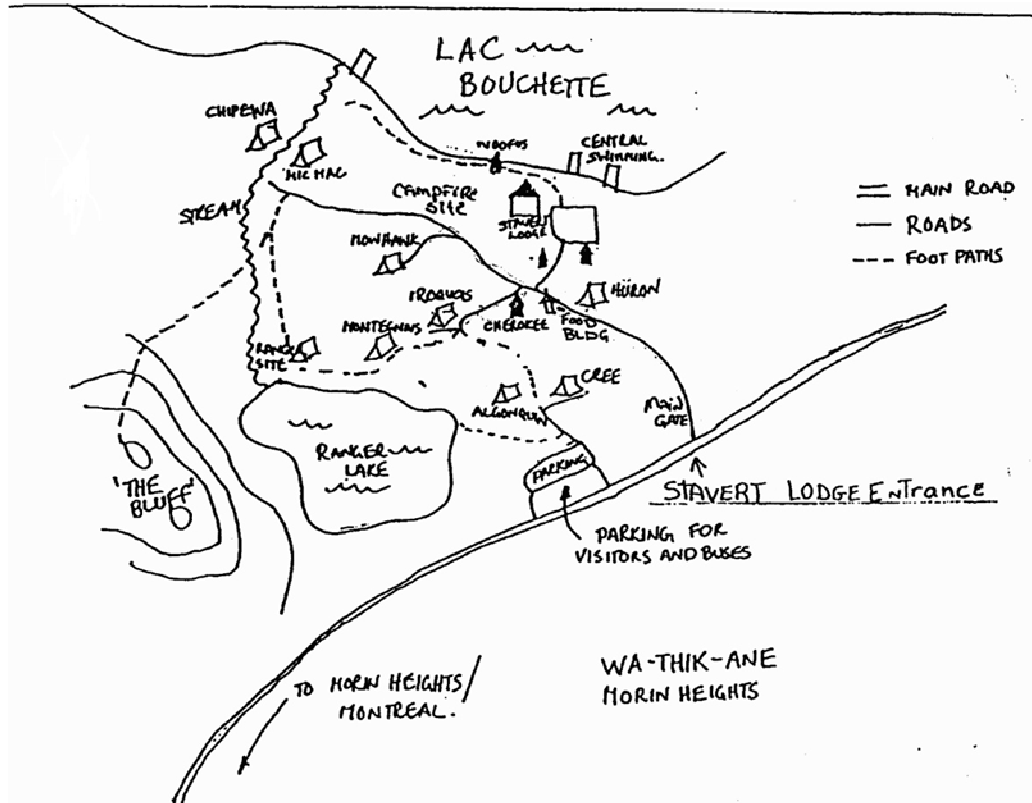

2011 Quebec Provincial Day Camp

Fall

FALL DAY CAMP at Wa-Thik-Ane



WHAT: Camp fun at the Guide Camp in Morin Heights. Camp skills, games, crafts and outdoor cooking

WHEN: Saturday October 1, 2011 - 9:30 am—7:30 pm*

*TRANSPORTATION—Departure approx. 8 am —return 9 pm

RETURN TRANSPORTATION - from locations indicated on the registration form at a cost of \$15 per PERSON - Guiders who are bringing 4 or more girls travel free.

WHO: Guiders of all branches and their girls

EACH Guider may bring 2-5 Sparks/Brownies or 2-7 Guides/Pathfinders/Rangers

Mixed groups must meet youngest girl ratios. A PRC checked adult female may accompany girls in place of a Guider, but will be expected to participate as a Guider in the program.

Guiders without girls are welcome as helpers

COST: \$ 25 per person (girls & adults)— includes 3 snacks, 2 meals, a crest, and activities PLUS transportation \$ 15 per person—see discount for Guiders above

EARLY BIRD DISCOUNT—Register before September 13 and save 5\$ per person

TO REGISTER: DEADLINE - 9 am Tuesday September 27, 2011

Complete the Registration form and you will be forwarded the SG1 & SG2, Parent and Guider information sheets (*No email ??— call the Provincial Office for a hard copy*)

A Tent and breakfast option for older girls with their guiders on Saturday night — Costs \$ 10 per person —Please note- No transportation Sunday

CAMP de JOUR D'AUTOMNE 2011 à Wa-Thik-Ane

Pour explications détaillé veuillez référer au texte anglais.

QUOI: Une journée d'activités et d'aventures dans la forêt au camp de Guides à Morin Heights

QUAND: le Samedi 1 octobre, 2011 - 9h30—19h30*

*TRANSPORT - Départ vers 8 h — retour vers 21 h—COUT de 15 \$ par personne

QUI: les animatrices de tous les niveaux avec les filles

Chaque animatrice peut amener 2 à 5 Sparks/Brownies ou 2 à 7 Guides-Pathfinders-Rangers

COÛT: 25 \$ par personne— 3 collations, 2 repas, un écusson et les activités

PLUS frais de transport à \$ 15 par personne— voir escompte pour animatrice ci-haut

ESCOMPTE DISPONIBLE —Inscrivez-vous avant le 13 septembre et sauvez 5\$ par personne

POUR S'INSCRIRE: Date limite : 9 h — mardi le 27 septembre

Compléter le formulaire et on vous envoie les SG1, SG2 et de renseignements



QUEBEC FALL DAYCAMP Information Sheet



The goal of this event is to encourage new campers and guiders to visit the camp and try camping without the concerns of the overnight or required planning and to give those who love camping already another chance to enjoy it before the winter.

- We will be offering different camp skill based activities
- We will be allowing time for Guiders to learn and play with their girls.
- We will be encouraging everyone to visit and explore our provincial campsite.
- We hope everyone will be able to share in the Sisterhood of Guiding

The tentative schedule for the day is:

7:30-8:00am	Buses depart various stops
9:15	Busses and vehicles arrive at camp
9:45	Opening Ceremony & Colours (flag raising)
10:00	Split into activity groups to focus on unit level appropriate camp skills Snack provided
12:00	Camp cookout – chose your menu – food provided
1:30	Outdoor Activity program – some choices available
3:30	Snack and wide games
4:30	Camp crafts, drama and camp challenges
5:30	Supper cooked for you
6:30	Campfire & snack
7:30	Busses and vehicles depart
9:00pm	Busses arrive various stops



TENT & BREAKFAST



Older girls and their guiders who wish to stay and camp on Saturday night may do so at a cost of \$10 per person for tent floor space, Saturday night snack and pancake breakfast. You must bring your own personal gear and sleeping bags, mattresses, groundsheets etc... a full kit list can be provided upon request. You will need to cook your own pancakes (stoves provided) Guiders will be in separate tents from the girls. Please note on the registration form, if your group is prepared to do a service project and help with day-camp clean-up for part of Sunday morning.

Registration – Deadline – Tuesday Sept 27 – 9 am

Please complete the attached registration form and return it as soon as possible by email or fax as indicated. \$ 25 Rate applies to ALL participants (Adults & Girls)

Early-bird discount - Register your group by September 13 and pay only 20\$ per person

Regular rate – register after September 13 (or add members to existing patrols) at \$25 per person.



Any questions can be forwarded to the Provincial Office or by email to QCGuidescamp@bell.net.

QUEBEC FALL DAYCAMP

Patrol Registration Form

(Please complete this form)

(return by email to OCGuidesCamp@bell.net or fax to Guide House)

NOTE: ONCE SUBMITTED you will be responsible for the fees whether or not you attend.

UNIT/GROUP NAME:	
UNIT Contact Name:	Phone/Email:
<i>Please note that girls MUST be split into Patrol groups which may do different activities for part of the day</i>	

PATROL 1 - PROGRAM level: Spark Brownie Guide Pathfinder Ranger			
<i>Please note if any patrol members wish to participate independently at another level.</i>			
<i>Please note below (A2) if an additional adult will be joining this patrol</i>			
Guider/Adult:	Name:	IMIS:	
GIRLS' Name	Level <i>(branch/ adult status)</i>	Imis # <i>(if available)</i>	Allergies/Food Restrictions
1	S B G P R		
2	S B G P R		
3	S B G P R		
4	S B G P R		
5	S B G P R		
6	G P R		
7	G P R		
A 2	Guider Parent		

PATROL 2 - PROGRAM level: Spark Brownie Guide Pathfinder Ranger			
<i>Please note if any patrol members wish to participate independently at another level.</i>			
<i>Please note below (A2) if an additional adult will be joining this patrol</i>			
Guider/Adult:	Name:	IMIS:	
GIRLS' Name	Level <i>(branch/ adult status)</i>	Imis # <i>(if available)</i>	Allergies/Food Restrictions
1	S B G P R		
2	S B G P R		
3	S B G P R		
4	S B G P R		
5	S B G P R		
6	G P R		
7	G P R		
A 2	Guider Parent		

ADDITIONAL PATROLS ON ANOTHER PAGE **yes** **no**

OVERNIGHT – Older girls with Guiders ONLY

We will stay for Saturday night Camping & Sunday breakfast

We expect to depart at _____ (latest 2 pm – lunch not included)

We realise we will NOT have access to our overnight gear until after 7:45 pm on Saturday

We will help with camp clean-up as a service project

UNIT/GROUP NAME:

Contact Name:

Phone/Email:

BUS/TRANSPORTATION

Our group will travel :

By Private car / We will make our own arrangements

NOTE: Arrival before 8:45 am – Departure after 7:45 pm

By GGC organised Bussing

Please select one stop on the list – they are **NOT Guaranteed** at this point but we will do our best. Please add a suggested stop if you have a group of 10 or more. Exact locations are to be determined

WEST	CENTRAL
St Lazare	Angrignon Mall/Metro
Dorion	St Laurent
Pincourt/Ile Perrot	Westmount High School
Fairview Shopping Center	Montreal West
Dorval Gardens Shopping Center	SOUTH
NORTH	St Bruno
Laval West	St Lambert
Laval East	Chambly
North of Laval	Chateauguay
	Hayes-Apple Valley

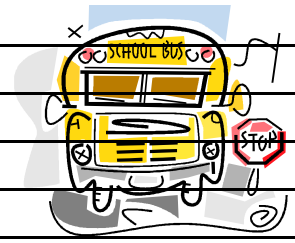

Other request:

We have enough people to arrange our own Bus transportation from:

CAMP FEES

Day Camp	# girls	+	# adults		TOTAL
\$ 20 (before Sept 12)		+		x \$20	
\$ 25 (Sept 12-28)		+		x \$25	
Overnight		+		x \$10	
BUS		+		x \$15	
	4 girls or more =		Free adult		
TOTAL					
<i>(Unit OR District Cheques ONLY - payable to GGC-Quebec Council)</i>					

PAYMENT BY CREDIT CARD

Name on Credit Card

Visa Mastercard

Credit Card Number

Expiry Date

/

Cardholder Signature:

Date: